

INSPECTION

1. **w/ Power Window:**
INSPECT DRIVER'S DOOR LOCK CONTROL SWITCH (MASTER SWITCH) CONTINUITY

Tester connection	Switch position	Specified condition
4 - 6	LOCK	Continuity
-	OFF	No continuity
4 - 12	UNLOCK	Continuity

If the continuity is not as specified, replace the switch.

2. **w/ Power Window:**
INSPECT PASSENGER'S DOOR LOCK CONTROL SWITCH CONTINUITY

Tester connection	Switch position	Specified condition
3 - 6	LOCK	Continuity
-	OFF	No continuity
3 - 5	UNLOCK	Continuity

If the continuity is not as specified, replace the switch.

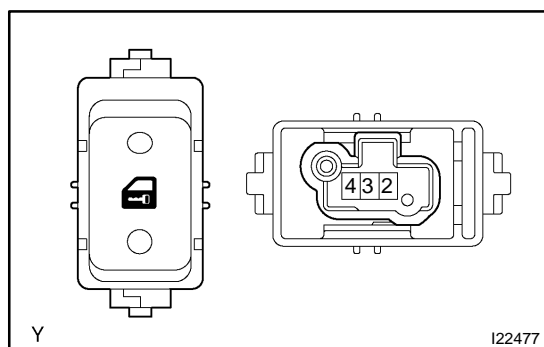
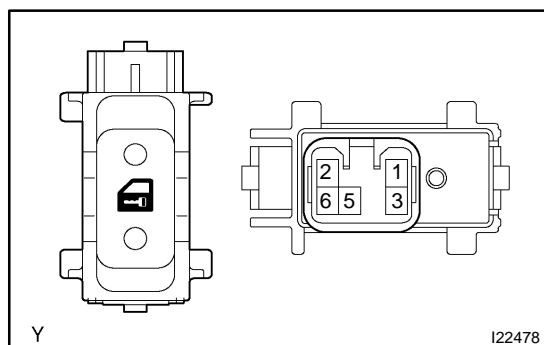

3. **w/o Power Window:**
INSPECT PASSENGER'S DOOR LOCK CONTROL SWITCH CONTINUITY

Tester connection	Switch position	Specified condition
3 - 4	LOCK	Continuity
-	OFF	No continuity
2 - 4	UNLOCK	Continuity

If the continuity is not as specified, replace the switch.

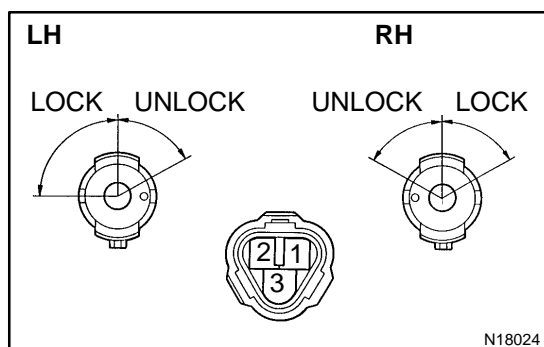

4. **INSPECT DOOR KEY LOCK AND UNLOCK SWITCH CONTINUITY**

Tester connection	Switch position	Specified condition
2 - 1	LOCK	Continuity
-	OFF	No continuity
3 - 2	UNLOCK	Continuity

If the continuity is not as specified, replace the switch.

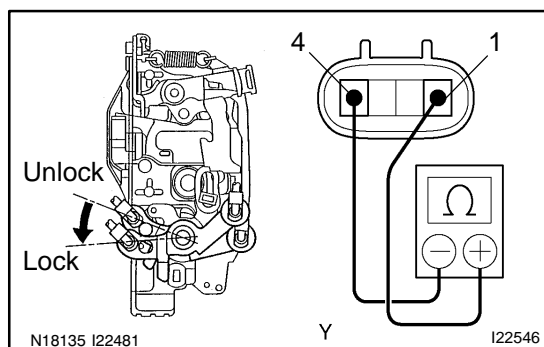

5. **INSPECT DRIVER'S DOOR UNLOCK DETECTION SWITCH CONTINUITY**

Tester connection	Switch position	Specified condition
1 - 4	OFF (Door Lock set to LOCK)	No continuity
	ON (Door Lock set to UNLOCK)	Continuity

If the continuity is not as specified, replace the switch.

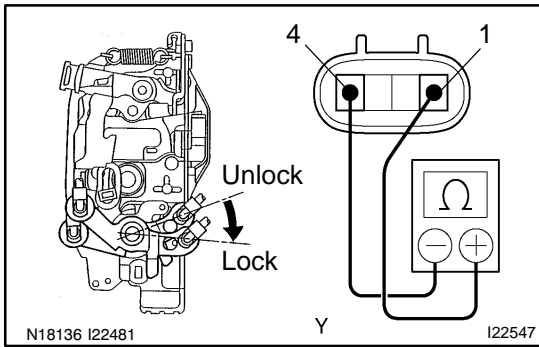

6. INSPECT PASSENGER'S DOOR UNLOCK DETECTION SWITCH CONTINUITY

Tester connection	Switch position	Specified condition
1 - 4	OFF (Door Lock set to LOCK)	No continuity
	ON (Door Lock set to UNLOCK)	Continuity

If the continuity is not as specified, replace the switch.

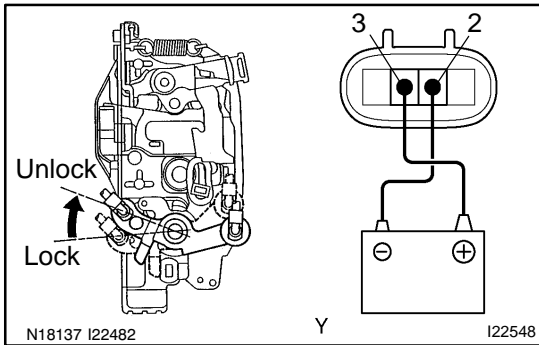

7. INSPECT FRONT DOOR LOCK MOTOR OPERATION

- (a) Connect the positive (+) lead from the battery to terminal 3 and the negative (-) lead to terminal 2, and check that the door lock link moves to UNLOCK position.

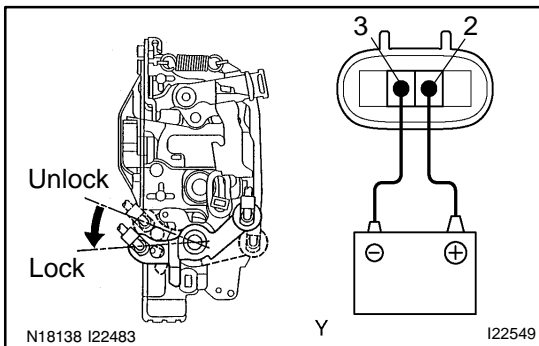

- (b) Remove the polarity and check that the door lock link moves to LOCK position.

If the operation is not as specified, replace the door lock assembly.

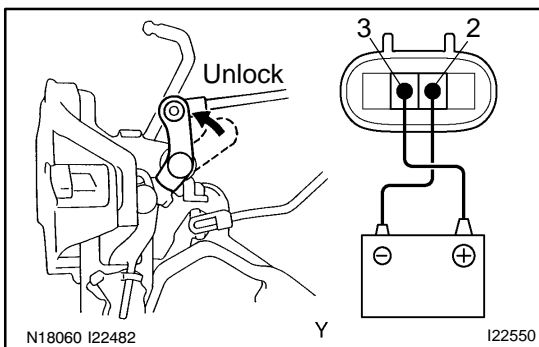

8. INSPECT REAR DOOR LOCK MOTOR OPERATION

- (a) Connect the positive (+) lead from the battery to terminal 3 and the negative (-) lead to terminal 2, and check that the door lock moves to UNLOCK position.

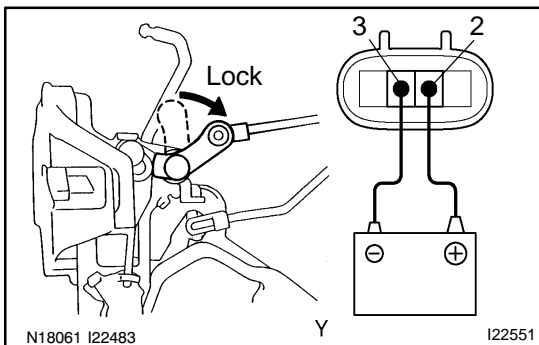

- (b) Remove the polarity and check that the door lock link moves to LOCK position.

If the operation is not as specified, replace the door lock assembly.

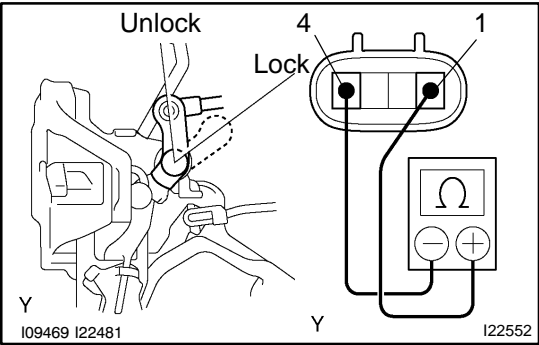

9. INSPECT REAR DOOR UNLOCK DETECTION SWITCH CONTINUITY

Tester connection	Switch position	Specified condition
1 - 4	OFF (Door Lock set to LOCK)	No continuity
	ON (Door Lock set to UNLOCK)	Continuity

If the continuity is not as specified, replace the switch.

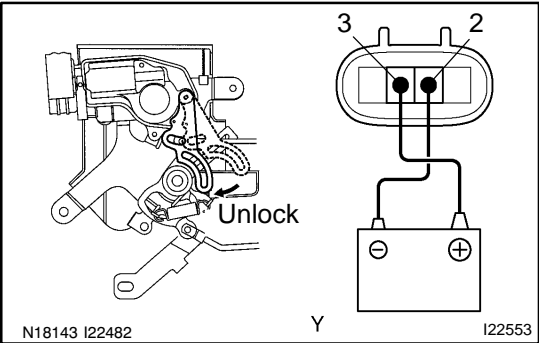

10. INSPECT BACK DOOR LOCK MOTOR OPERATION

- (a) Connect the positive (+) lead from the battery to terminal 3 and the negative (-) lead to terminal 2, and check that the door lock link moves to UNLOCK position.

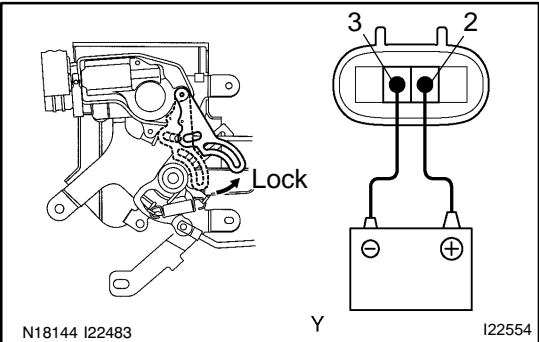

- (b) Remove the polarity and check that the door lock link moves to LOCK position.

If the operation is not as specified, replace the door lock assembly.

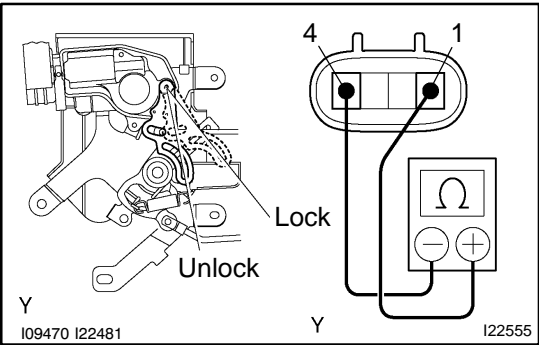

11. INSPECT BACK DOOR UNLOCK DETECTION SWITCH CONTINUITY

Tester connection	Switch position	Specified condition
1 - 4	OFF (Door Lock set to LOCK)	No continuity
	ON (Door Lock set to UNLOCK)	Continuity

If the continuity is not as specified, replace the switch.